

Jabo Street light



Features

- Housing is made of very anti corrosion resistant high pressure die-cast aluminium with polyester powder coated treatment.
- Toughened glass with high light transmittance to optimize the light output ratio.
- Thermal management protect for LED module.
- Stainless steel bracket to secure the cover in open position for maintenance.
- Silicon gasket and embedded vent caps guarantee ip66 for complete luminaire.



Installation
Street



IK Rating
IK09



IP Rating
IP66



Standard Warranty

TECHNICAL DATA SHEET - JABO - STREET LIGHT



TECHNICAL DATA

Product Data	Street Light
Lamp Type	CREE LED
Driver	PHILIPS
Color Temperature	3000K, 4000K
Rated Luminaire Efficiency	Upto 125lm/W
IP Rating	66
Beam Angle	Side entry -15°-10°-5°,+5°,+10°,+15° Top entry -15°-10°-5°,+5°,+10°,+15°
Installation Height	6-14 M
Voltage	AC120 - 277V
Frequency Range	50-60 Hz
CRI	Ra>80
Power Factor	>0.95
Operating temperature	-20 °C to +50 °C
L&B Rating	L90/B10 80000 Hrs L80/B10 93000 Hrs
Safety Class	CLASS I / CLASS II
Material	Die-cast aluminium+ tempered glass
Finish	Dark Grey
Life Span	70,000 Hours
Warranty	7 Years
Applications	Street, Roadway

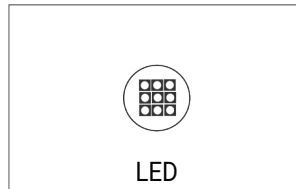

Horizontal Installation

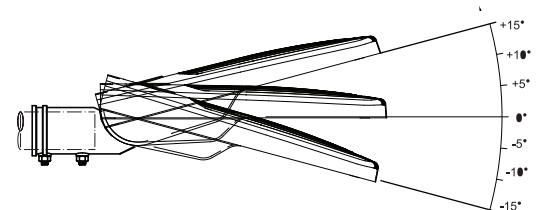

Post Top Installation

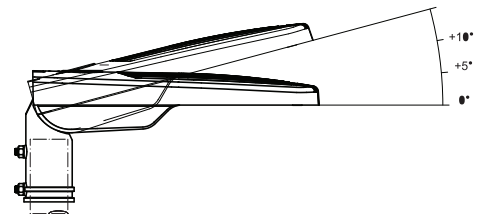

TECHNICAL OPTIONS

Wattage	51W to 137W
Control	Switchable, DALI, TRIAC, 0-10V
Mounting	Bracket or Post-top Ø60mm Ø48mm (OPTIONAL) , Ø76mm (OPTIONAL)

TECHNICAL DATA SHEET - JABO - STREET LIGHT

SKU	Wattage	CCT	Lumen	Output Current	Dimension(mm)
16723	103W	4000K	12875lm	700mA	702x314x130
16724	135W	4000K	16875lm	700mA	702x314x130

DIMENSION

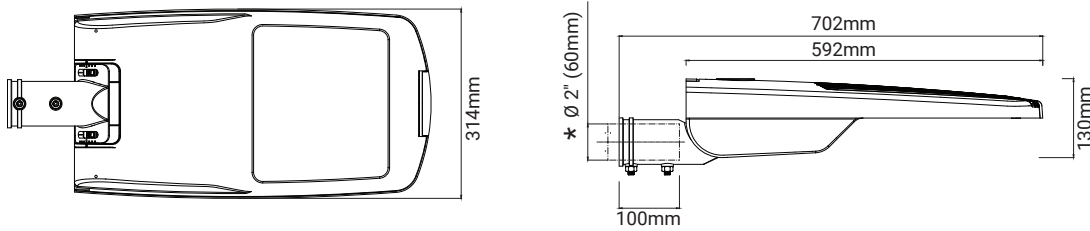

PHOTOMETRICS

