

Juno

Wall Washer Strip light



Description

- PU material: anti-yellow: High temperature durable; corrosion resistance; weak acid and alkali resistance; good flexibility.
- PU glued, strong adhesion, good durability and high reliability.
- It can replace the traditional aluminum heavy wall washer or LED light bar due to its small size light weight, flexible and easy to install.



Surface Mounted



IK Rating
IK08



IP Rating
IP67



Standard Warranty

TECHNICAL DATA SHEET - JUNO - 19422 - WALL WASHER STRIP LIGHT



TECHNICAL DATA

Product Data	Wall washer strip light
Lamp Type	PHILIPS LED
LED Qty	56led/mtr
Wattage	12W/mtr
Color Temperature	4000K
Rated Luminaire Luminous Flux	1440lm
Rated Luminaire Efficiency	120lm/W
IP Rating	67
Beam Angle	30°
Voltage	DC24V
Frequency Range	50-60 Hz
CRI	Ra>90
Power Factor	>0.9
Humidity	0-95% non condensing
Working Temperature	-25°C~+55°C
Material	PU
Lens	PMMA
Finish	White
Life Span	50,000 Hours
Warranty	5 Years
Applications	Outdoors, Residential, Commercial, Hospitality etc.

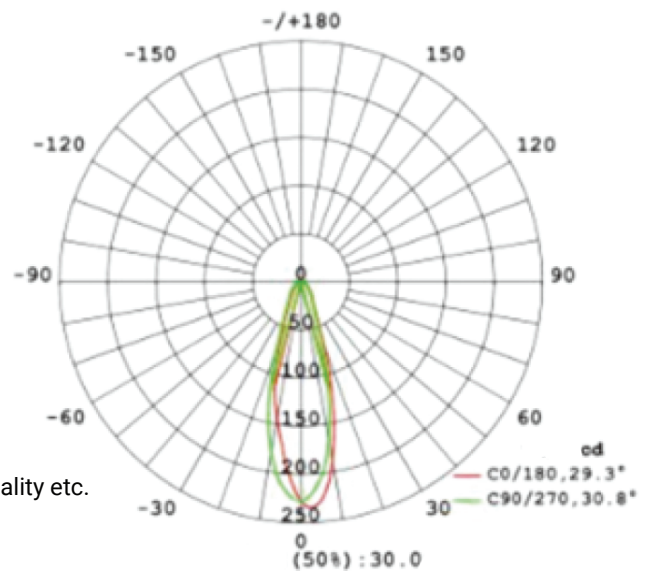
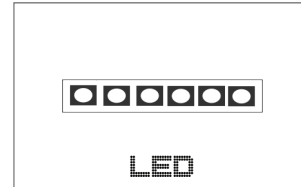

TECHNICAL OPTIONS

Wattage	70W/140W
Color Temperature	3000K, 6500K
Control	Switchable, TRIAC, 1-10V, Dali

TECHNICAL DATA SHEET - JUNO - 19422 - WALL WASHER STRIP LIGHT

DIMENSIONS

Cut Unit: 125mm

Top view

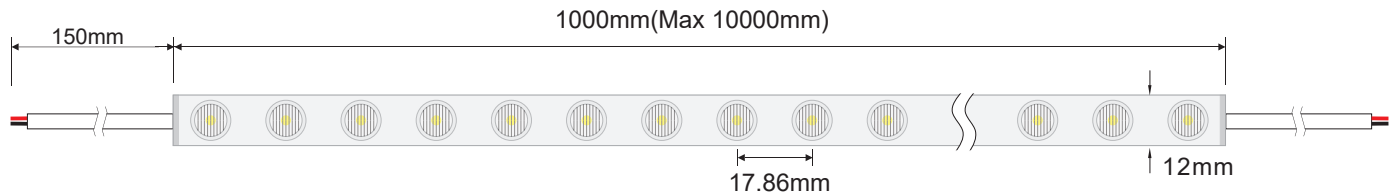

Side view

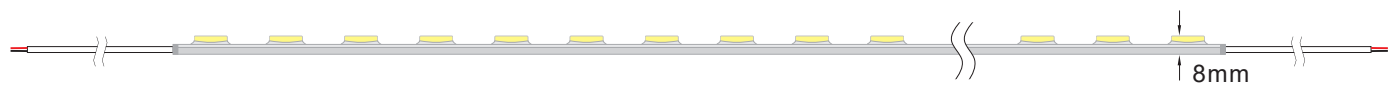

Bottom view

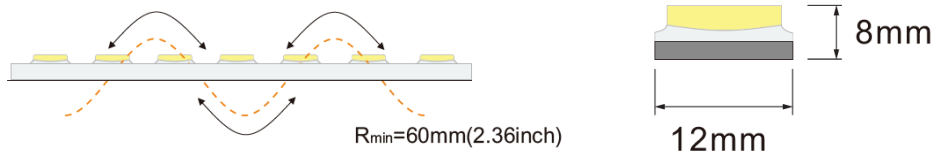
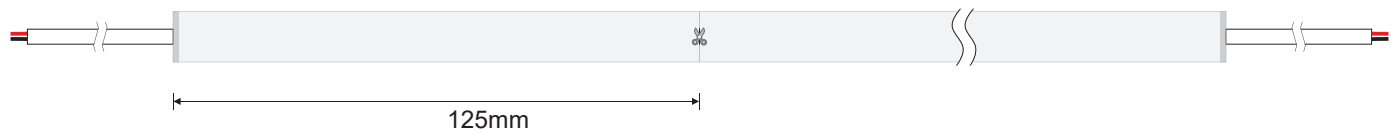

TECHNICAL DATA SHEET - JUNO - 19422 - WALL WASHER STRIP LIGHT

INSTALLATION DISTANCE/WALL WASHING HEIGHT

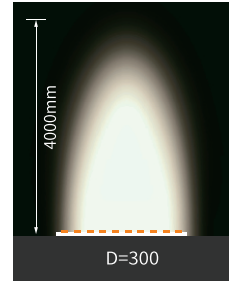
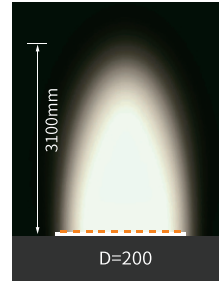
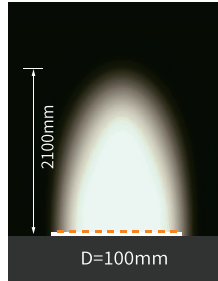
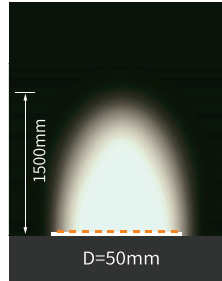
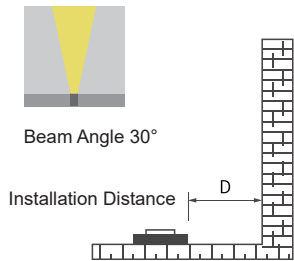

ACCESSORIES

Name	Image	Sectional size	Description	Remark
Mounting clip			Flat mounting clip	For wall washer light
Aluminum channel			Flat mounting aluminum groove	Size: L1000*W14.8*H8mm, with screw
Aluminum channel			Flat mounting aluminum groove	Size: L1000*W23*H20.67mm, with screw
PVC clip		/	A clamp capable of holding objects in place and transmitting light	For wall washer light
Red 3M tape		/	Super sticky tape	Van toepassing op al ons produkte

TECHNICAL DATA SHEET - JUNO - 19422 - WALL WASHER STRIP LIGHT

CLIPS MOUNTING

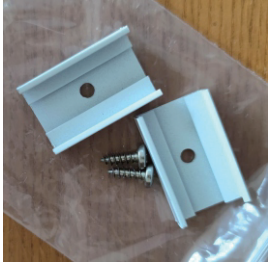

Stainless Steel Mounting Clips

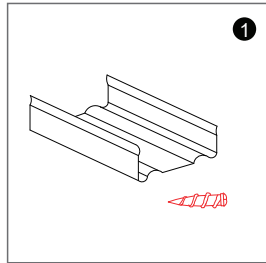

1 Prepare for screws and clips

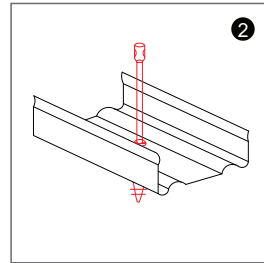

2 Drive the screw into the clips

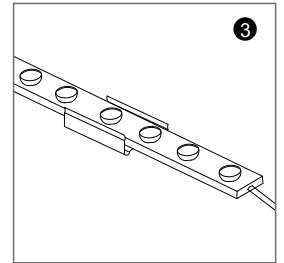

3 Put the light strip into the clip, installed to complete

ALUMINUM CHANEL MOUNTING



Aluminum Profile

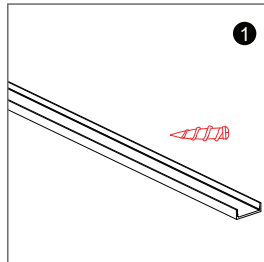

1 Prepare aluminum channel and screws

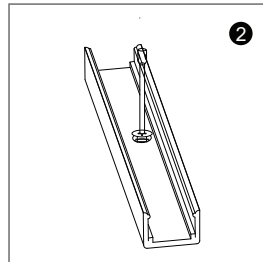

2 Drive the screw into the aluminum groove

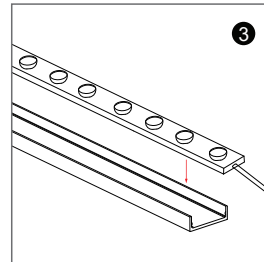

3 Put the light strip into the aluminum groove in the direction of the arrow

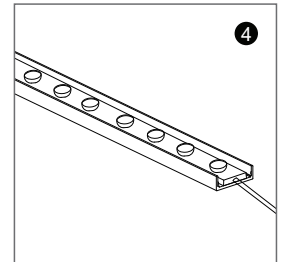

4 Installed to complete

SILICONE CLIPS MOUNTING & VHB 3M TAPE



VHB 3M Tape



Plastic Holding Clips

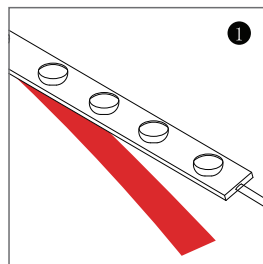

1 Prepare the silicone clip silicone clip to fix

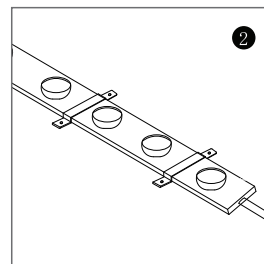

2 Put the light strip into the clip

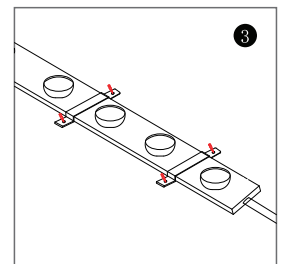

3 Screw the screws into the

TECHNICAL DATA SHEET - JUNO - WALL WASHER STRIP LIGHT

Cautions

CORRECT OPERATION

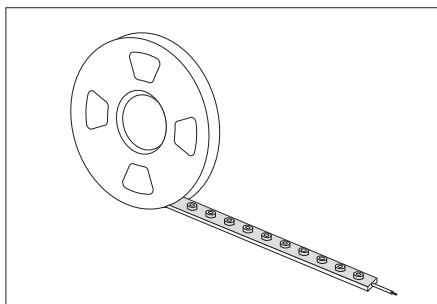

During the installation process, the LED wall washer is taken out from the reel naturally and keep it as straight as possible.

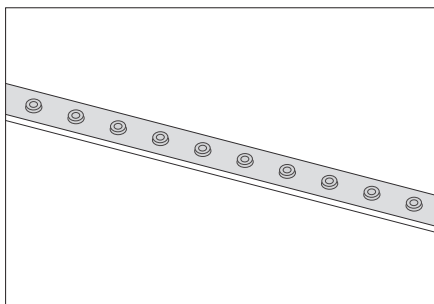

The LED wall washer should be kept vertical or horizontal during the installation process.

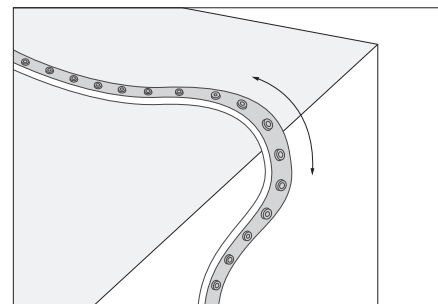

When LED wall washer meets the corner during the installation process, the LED wall washer must be kept facing up and the back facing down, maintaining a certain bending arc, $\Phi \geq 150\text{mm}$.

WRONG OPERATION

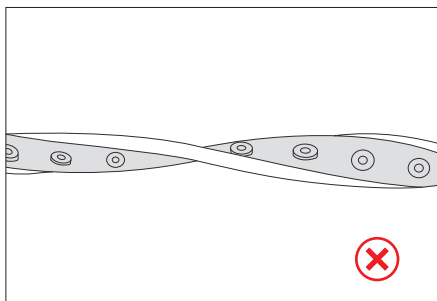

Do not twist the LED wall washer during the installation process.

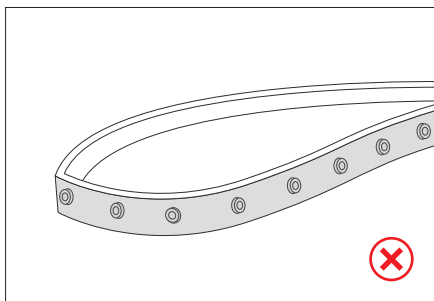

Do not fold the LED wall washer in half or bend it at a small angle during the installation.

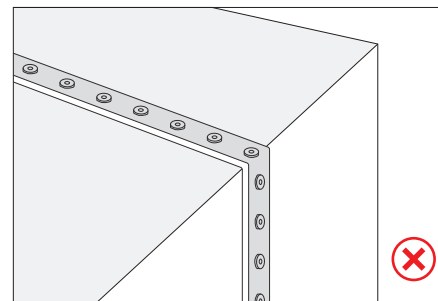

When the LED wall washer meets the corner during the installation process, the LED wall washer must be kept facing up and the back down, and it cannot be bent at right angles.

TECHNICAL DATA SHEET - JUNO - WALL WASHER STRIP LIGHT

Installation Diagram:

1. Regular connection

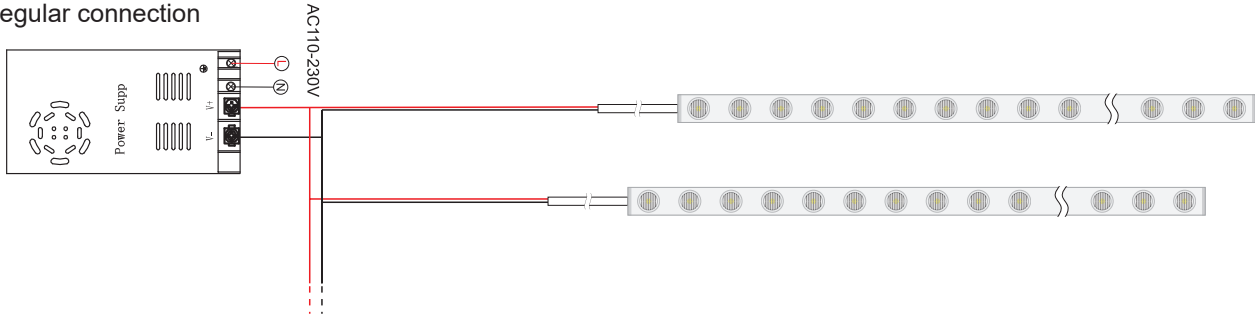

2. connection with dimmer

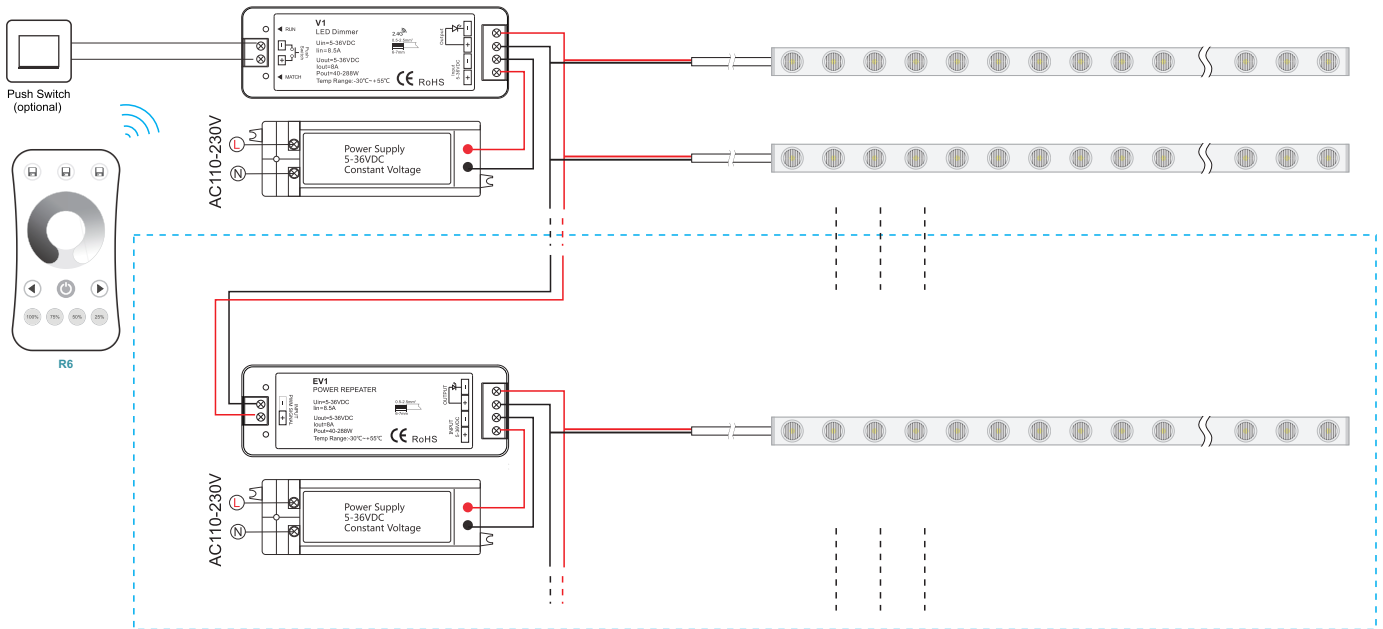

3. DMX Connection

