

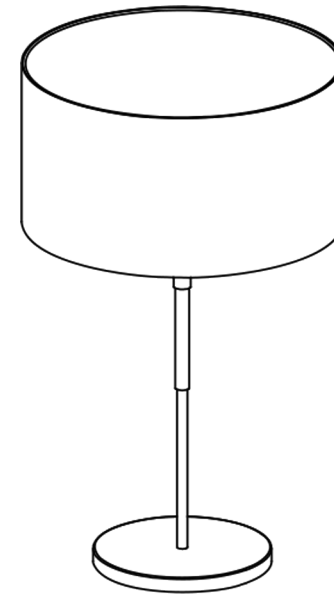

Tendency Table Lamp

Assembly Instructions
SKU 14981

AC220-240V 50/60Hz
E27 x 1 Max. 60W



CONTENTS

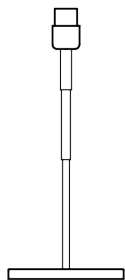

1 x shade

BEFORE YOU START

- It is extremely important that these instructions are read carefully and any illustrations studied before commencing installation .
- Please retain these instructions for future reference.

WARNING!

- Electricity can be dangerous.
- Do not attempt to fit installation unless you are competent.
- If in any doubt consult a qualified electrician to complete electrical installation.
- Installation to comply with current IET wiring regulations
- The lighting is for use in a normal dry domestic indoor environment.

Installation Manual

- Type Y attachment : Method of attachment of the cable or cord such that any replacement can only be made by the manufacturer, his service agent or similar qualified person.

Cleaning Instructions and Care

- Take extra care when cleaning and assembling.
- Do not use any chemical or abrasive agents to clean the shade.

Table Lamp Assembly

- Remove the wrap from the shade.
- Install the shade with ring.
- Put the bulb into lampholder

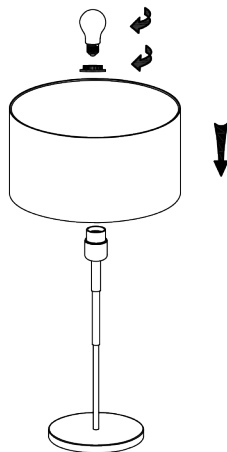

Bulb Replacement

- 60w E27(screw type) GLS bulb.
- Dispose of old bulbs with care.

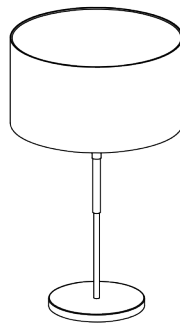

Your light is now ready for use.