

**RECESSED LED PANEL**  
User Manual

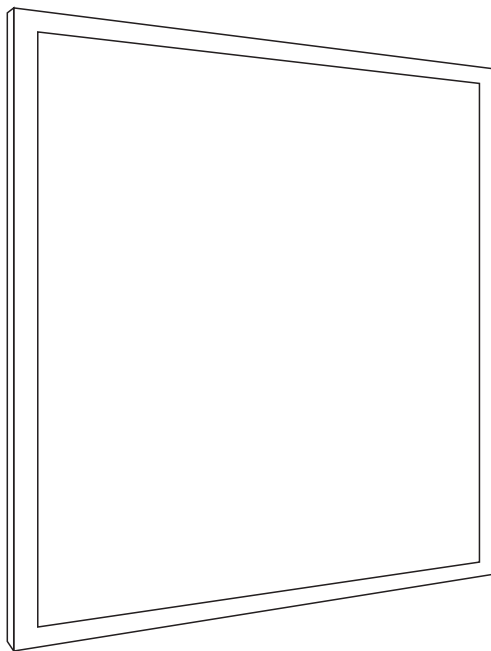

All the pictures are just for reference and we have the final explanation rights

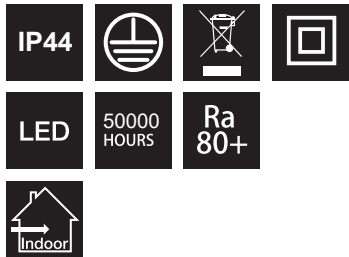

**Item List**

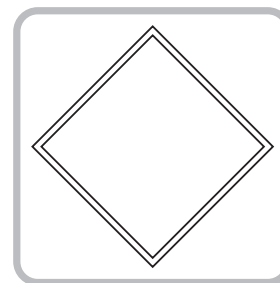

LED PANEL LIGHT

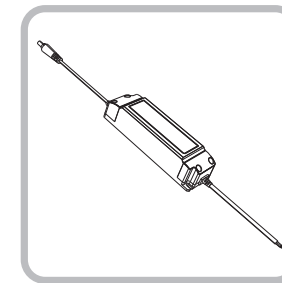

Driver

**Size**

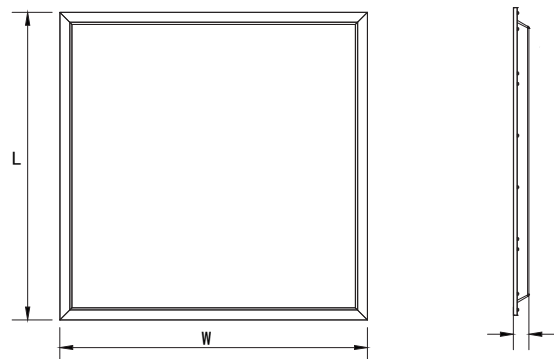

MODEL	L X W X H (mm)
<b>SYV30-6060</b>	<b>595 x 595 x 30 mm</b>
<b>SYV36-6060</b>	<b>595 x 595 x 30 mm</b>
<b>SYV40-6060</b>	<b>595 x 595 x 30 mm</b>

# Installation

\*\*\*Cut off power before installation.

## Recession

\*\*\*Customers can choose safety rope to avoid lamp falling caused by uncertain factors (earthquake, etc).

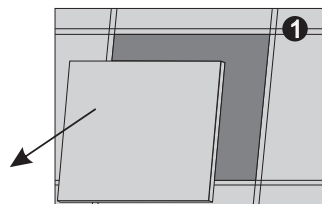

1. Remove the plasterboard from the ceiling.

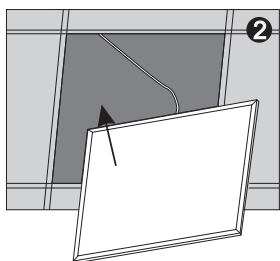

2. Fix the panel into ceiling.

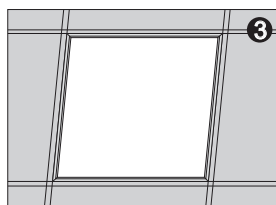

3. Installation finished.

## Suspension

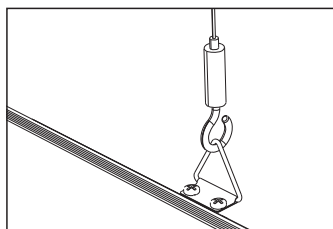

## Mounted Frame

### • Surfaced Mounted Frame

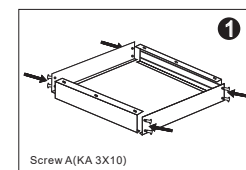
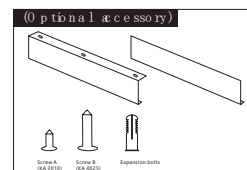

1. Assemble the four frames with Screw A to a whole square.

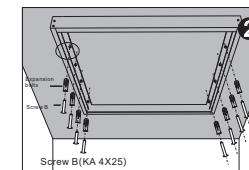

2. Fix the square frames to the ceiling with Screw B.

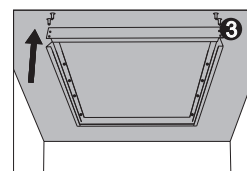

3. Demount one frame

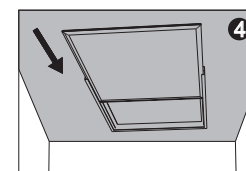

4. Put the panel into the frame square.

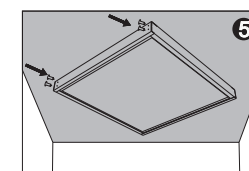

5. Fix the last frame with screw A.

### • Recessed Frame

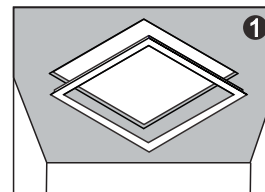

1. Put the frame into the hole

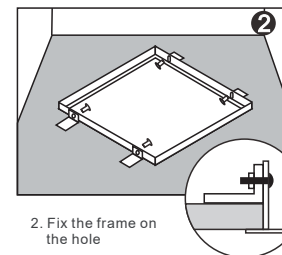

2. Fix the frame on the hole

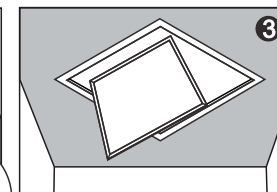

3. put the panel in to the recessed mounted frame.

## Notes

1. Indoor purpose only.
2. Installation shall be done by qualified electrician.
3. Make sure panel is in perfect condition before installation.
4. Don't stare at the light emitting surface for long time.
5. Keep away from children.
6. Luminaire should not be covered, be away from fire or high-temperature substance.
7. Manufacturer reserves the right to offer no replacement or warranty to the led panels dissembled or repaired by users themselves.
8. Cut off power before installation.
9. The light source of this luminaire is not replaceable.
10. The external flexible cable or cord of the panel light cannot be replaced.