

Installation Instruction

Attention

1. Make sure the power is off when installing the lamp.
2. Please read the installation instructions before installing the lamp, provided with the lamp to avoid injury or loss due to improper operation.
3. If cleaning the lamp, make sure the power is off and wipe it with a non-corrosive cleaner.

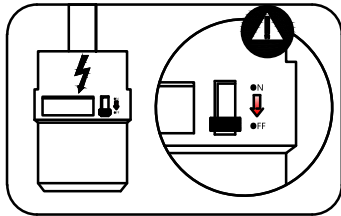

01

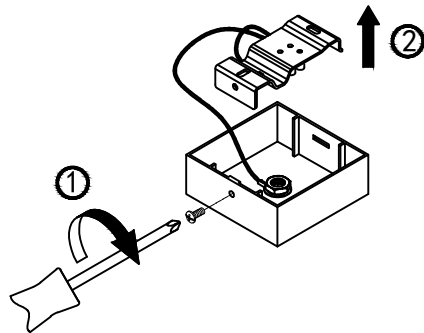

02

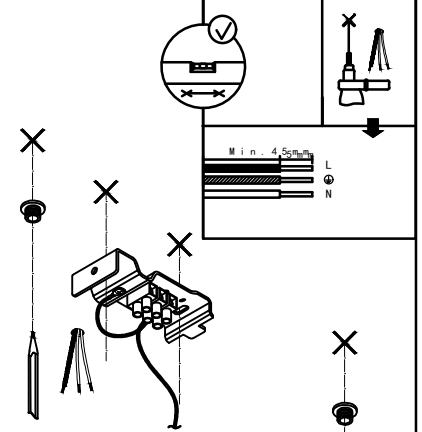

03

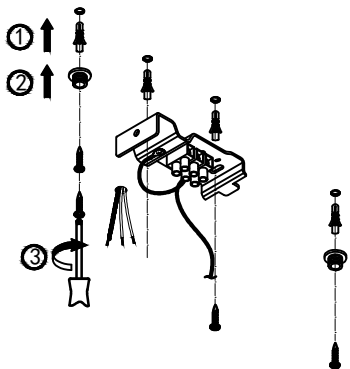

04

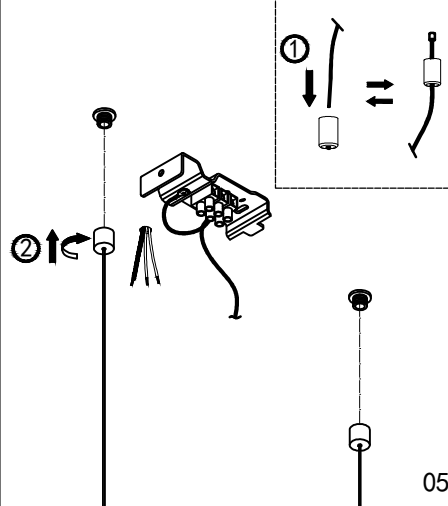

05

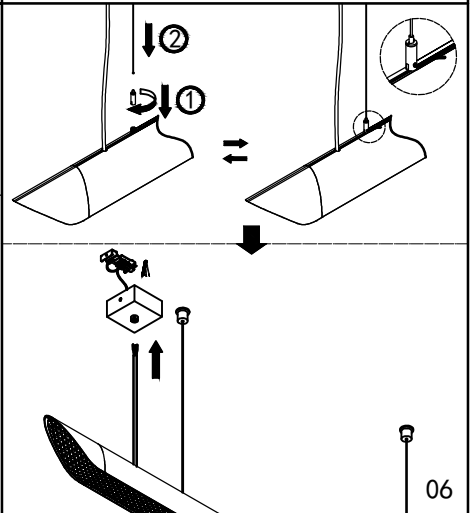

06

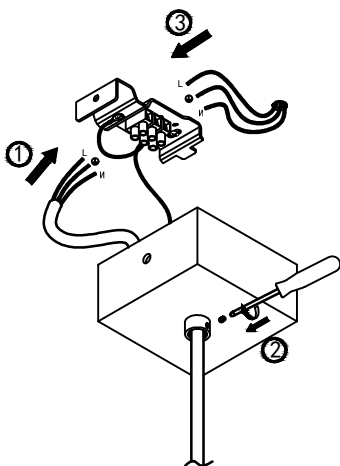

07

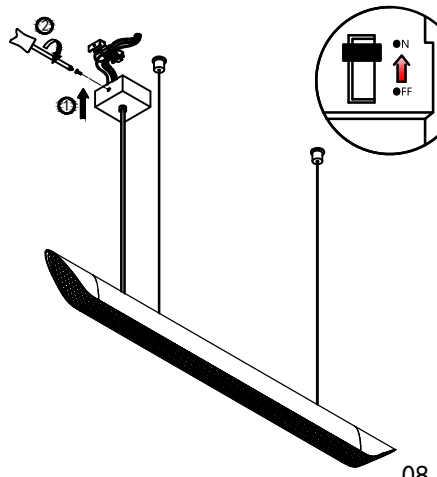

08

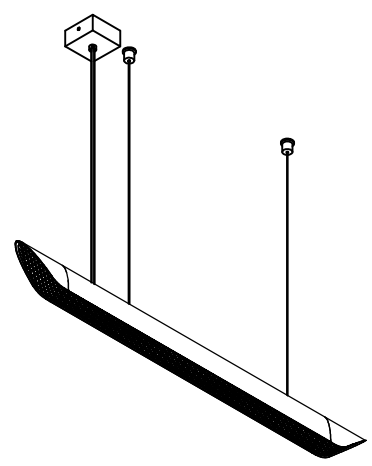

09