

INSTRUCTIONS



**Please operate strictly according to the Instruction
Don't modify the product randomly,only for indoor use**

WARNING:

Apply to AC 220–240V 50Hz.

It is suitable for stable wall or wooden surface.

Do not use the lamp in a high temperature area in order to avoid lamp damage.

The lamp is not designed for dimmer.

Ask a qualified electrician to inspect or install the lamp to avoid any danger.

Please ask a qualified electrician to maintain or replace the product when component is destroyed or the product work abnormally .

LED lighting source,do not stare at the lights for long time.

Do not open the product,the Led lighting source is irreplaceable.

INSTALLATION MANUAL



Cut off power before installation

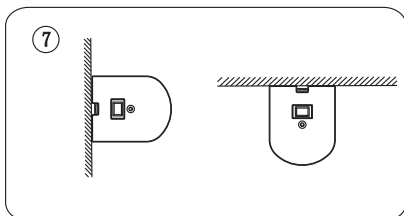
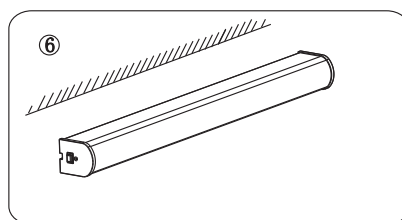
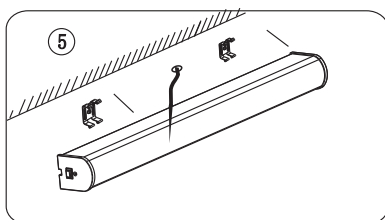
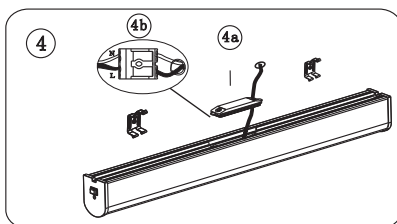
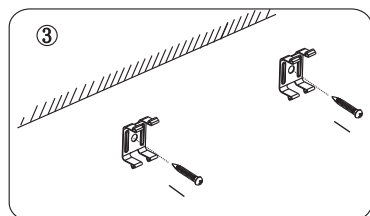
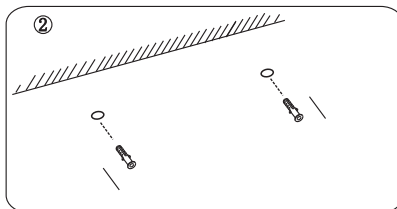
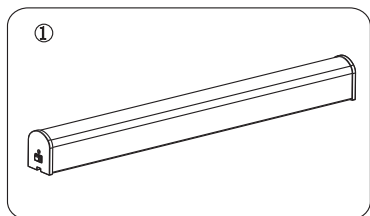

Attention: please check whether the lamp is fixed and wired properly if the lamp doesn't work while switching on.