

## Wogue MOTION Sensor



### Features

- The product is a new saving-energy product; it adopts microwave sensor mould with high-frequency electro-magnetic wave (5.8GHz) and integrated circuit.
- It gathers automatism, convenience, safety, saving- energy and practical functions.
- The wide detection field depends on detectors.
- It works by receiving human motion.

 Surface

 IP Rating  
IP44

**5** years  
warranty **Standard Warranty**

## TECHNICAL DATA SHEET - WOGUE - 13350 - MOTION SENSOR



### TECHNICAL DATA

<b>Product Data</b>	MOTION Sensor
<b>Rated Load</b>	1200W(incandescent lamp) 300W (energy-saving lamp)
<b>Power Consumption</b>	approx 0.9W
<b>Transmission Power</b>	<0.2mW
<b>IP Rating</b>	44
<b>Ambient Light</b>	<3-2000LUX (adjustable)
<b>Time-Delay</b>	Min: 10sec±3sec Max: 12min±1min
<b>Detection Distance</b>	1-8m (radius), adjustable
<b>Detection Range</b>	360°
<b>Installation Height</b>	1.5 - 3.5m
<b>Detection Motion Speed</b>	0.6 ~1.5m/s
<b>HF System</b>	5.8GHz CW radar, ISM band
<b>Voltage</b>	AC220-240V
<b>Frequency Range</b>	50/60Hz
<b>Material</b>	ABS + UV
<b>Finish</b>	White
<b>Life Span</b>	50,000 Hours
<b>Warranty</b>	5 Years
<b>Applications</b>	Residential, Commercial, Hospitality etc.

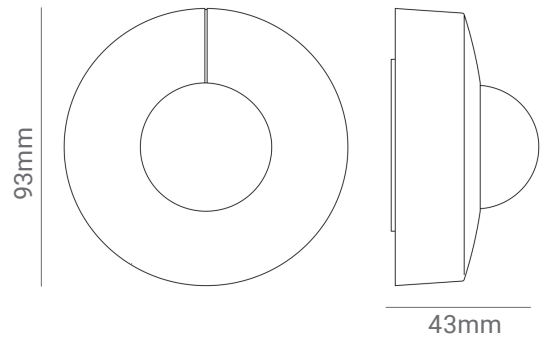

## TECHNICAL DATA SHEET - WOGUE - 13350 - MOTION SENSOR

### FUNCTION

- Can identify day and night: It can work in the daytime and at night when it is adjusted on the "sun" position (max). It can work in the ambient light less than 3LUX when it is adjusted on the "3" position (min). As for the adjustment pattern, please refer to the testing pattern.
- SENS adjustable: It can be adjusted according to using location. The detection distance of low sensitivity could be only 2m and high sensitivity could be 16m which fits for large room.
- Time-Delay is added continually: When it receives the second induction signals within the first induction, it will restart to time from the moment.
- Time-Delay is adjustable. It can be set according to the consumer's desire. The minimum time is 10sec±3sec. The maximum is 12min±1min.

NOTE: the high-frequency output of this sensor is <10mW- that is just one 100th of the transmission power of a mobile phone

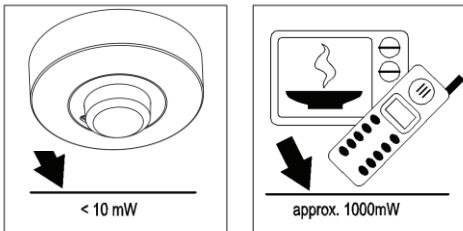

### INSTALLATION

- Switch off the power.
- Please whirl the upper cover anti-clockwise to unload it.
- Connect the power and the load with the sensor as per the connection-wire diagram.
- Fix the bottom on the selected position with the inflated screw.
- Install back the upper cover. Then you could switch on the power and test it.

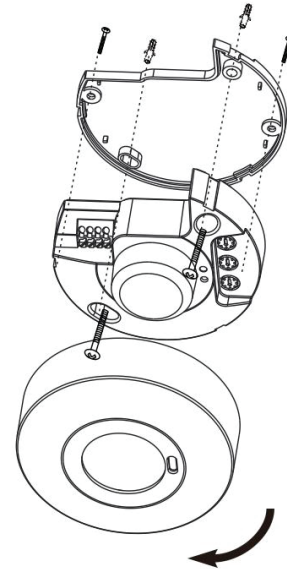

### CONNECTION WIRE DIAGRAM

